

### 3-POSITION PRESSURE CONTROL HANDLE ASSEMBLY

The pressure control handle assembly is a three-position detent control that selects a HydraPak output of either 1750, 2000, or 2500 psi at 0-10 gpm with low effort adjustment. In the extreme clockwise position, the valve selects 2000 psi. Two counterclockwise rotations of 45° each select pressure values of 2500 and 1750 psi, respectively.

#### BEFORE INSTALLATION

1. Read these instructions thoroughly before starting work. If you don't understand a procedure, call Reimann & Georger Corporation or its distributors for assistance.
2. Insure that you have all the parts listed as shown below. Each item number on this parts list can be matched with the item number shown on the assembly drawing at the end of these instructions. If any parts are missing or damaged, return to place of purchase immediately. Do NOT substitute any components.

Item No.	Quantity	Description
1	1	HANDLE SCREW
2	1	INLAY
3	1	HANDLE SUB-ASSEMBLY
4	1	SPRING
5	1	DETENT PIN
6	1	TAPERED HANDLE
7	1	BASE PLATE
8	1	SPACER
	1	3/32 HEX KEY WRENCH
9	1	CARTRIDGE

3. Review and follow all the safety rules given in Chapter 1 of the HydraPak manual before proceeding.
4. Refer to the assembly drawing included at the end of these instructions for both the removal and installation procedure.

#### REMOVING EXISTING ASSEMBLY

1. Shut down the HydraPak and allow the system to cool before doing any maintenance or repairs.



#### **WARNING:**

**DO NOT ADJUST OR REMOVE HYDRAULIC COMPONENTS, LINES, OR FITTINGS WHILE THE HYDRAPAK IS RUNNING OR WHENEVER THE HYDRAULIC FLUID IS HOT. LIQUID UNDER HIGH PRESSURE CAN PIERCE THE SKIN, CAUSING DEATH OR SERIOUS INJURY. IN CASE OF INJURY, GET IMMEDIATE MEDICAL ATTENTION.**

**PREVENT ACCIDENTAL STARTUP BY DISCONNECTING THE NEGATIVE WIRE FROM THE BATTERY TERMINAL.**

2. Use the hex key wrench to loosen the handle screw. Then remove the handle screw and the inlay.
3. Use the hex key wrench to loosen the two set screws in the handle. Then lift the handle up and off the cartridge stem. After removing the handle from the stem, carefully store the spring and detent pin where they will not get lost.
4. Slide the spacer up and off the cartridge stem.

5. Loosen the three set screws supplied with the base plate. Then lift the base plate off the cartridge.
6. Remove the cartridge valve from the manifold cavity.

#### **INSTALLING NEW ASSEMBLY**

1. Install the cartridge valve into the manifold cavity as follows.
  - a. Inspect the cartridge to insure that the screen is clean.
  - b. Insure that O-rings and back-ups are intact and correctly positioned.
  - c. Apply a light coating of hydraulic fluid to the O-rings on the cartridge. Screw in the cartridge **BY HAND**; then torque to 25 ft.-lbs.
2. Set the cartridge valve to the 2000 psi or “3 o’clock” position by turning the stem fully clockwise. The spacer can be used to help turn the stem. It is **NOT** necessary to align the marks on the stem and the cartridge.
3. Place the base plate over the cartridge. Orient it with the holes aligning with the 3 lines on the decal.
4. Tighten the three set screws supplied with the base plate.
5. Apply a light grease coating to the three holes in the base plate.
6. Orient the spacer as shown in the assembly drawing and slide it onto the stem.
7. Use the hex key wrench to adjust the two handle set screws flush with the outside diameter of the handle.
8. Insert the spring into the handle. Then insert the detent pin such that the pointed end of the pin will engage the holes when installing the handle onto the stem.
9. Apply a light coating of grease to the detent pin and spring. This will prevent them from falling out of the handle when it is turned over for installing onto the stem.
10. Turn over the handle. Position the detent pin over the 2000 psi position hole of the base plate at the “3 o’clock” position. Slide the handle over the stem and place the detent pin in the 2000 psi position hole.
11. Press down on the handle. Use the hex key wrench to tighten the two set screws. Evenly tighten the screws 1-1/2 to 2 ft.-lbs.
12. Position the inlay such that the arrowhead aligns with the 2000 psi position hole in the base plate at the “3 o’clock” position.
13. Insert the handle screw and tighten. Use the hex key wrench to tighten the screw firmly.
14. Check the assembly by rotating the handle counterclockwise. If the handle does not rotate 90°, or there are not two clicks, loosen the handle screw and two handle set screws. Remove the inlay and handle. Turn the stem fully clockwise and repeat steps 8 through 13.
15. After completing the pressure control handle installation, start the HydraPak as described in the separate instruction manual. These procedures must be followed to insure the safety of all personnel and the proper performance of the equipment.

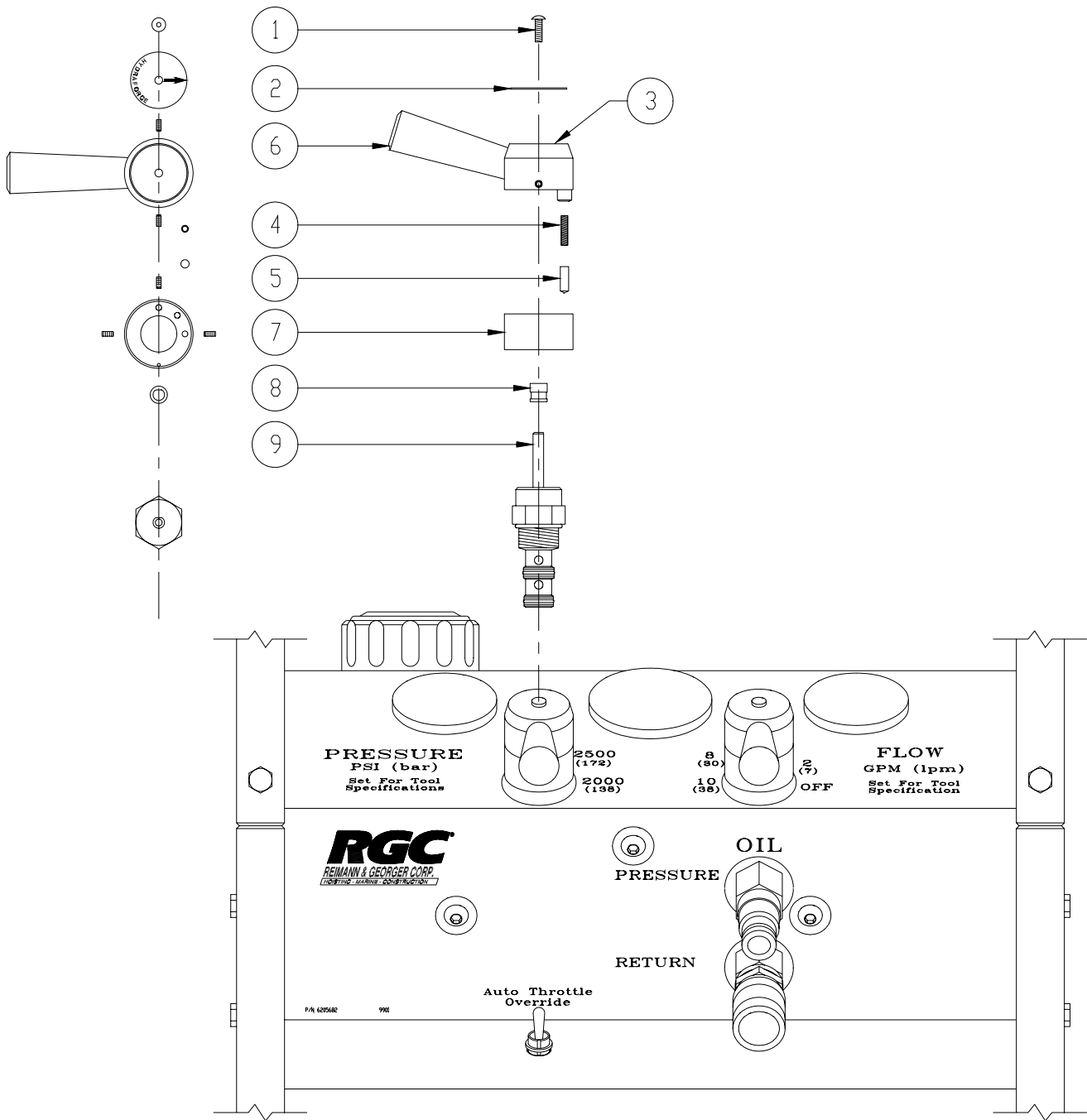

**Pressure Control Handle Assembly**