



B200-V 12-VOLT POST & POLE PULLER (BUCJAC) INSTRUCTIONS

**REIMANN & GEORGER CORPORATION
CONSTRUCTION PRODUCTS
P/N 6122102**

**BUFFALO, NY
7/24/02**

TABLE OF CONTENTS

CHAPTER	TITLE	PAGE
1	SAFETY	1
1.1	Introduction	1
1.2	Safety Definitions	1
1.3	BucJac B200-V Safety Rules	1
2	SPECIFICATIONS	3
2.1	Introduction	3
2.2	Technical Data	3
2.3	Recommended Hydraulic Oil	3
2.4	Nameplate and Serial Number Tag	3
3	OPERATION	5
3.1	Before Operating the BucJac	5
3.2	Setup Procedure	5
3.3	Post Pulling Procedure	5
3.4	Shutdown and Storage	7
4	INSPECTION AND MAINTENANCE	9
4.1	General Maintenance Rules	9
4.2	Required Maintenance	9
5	TROUBLESHOOTING	11
6	PARTS LIST	13
	LIMITED WARRANTY	15

LIST OF FIGURES

FIGURE	DESCRIPTION	PAGE
2-1	Typical BucJac Product Nameplate	3
3-1	12-Volt Power Connection	6
3-2	Chain Installation on Post to be Pulled	6
3-3	LinkLok™ Installation	7
6-1	B200-V BucJac Assembly	14

1 SAFETY

1.1 INTRODUCTION

Your Reimann & Georger Corp., B200-V BucJac has been engineered to provide post pulling performance, long term economics and safety advantages that no other type can match. However, even a well-designed and well-built post puller can malfunction or become hazardous in the hands of an inexperienced and/or untrained user. Therefore, read this manual and related equipment manuals thoroughly before operating your BucJac to provide maximum safety for all operating personnel, and to get the maximum benefit from your equipment.

1.2 SAFETY DEFINITIONS

A safety message alerts you to potential hazards that could injure you or others or cause property damage. The safety messages or signal words for product safety signs are **DANGER**, **WARNING**, and **CAUTION**. Each safety message is preceded by a safety alert symbol and is defined as follows:

DANGER: Indicates an imminently hazardous situation, which, if not avoided, **will** cause death or serious injury. This safety message is limited to the most extreme situations.

WARNING: Indicates a potentially hazardous situation which, if not avoided, **could** result in death or serious injury.

CAUTION: Indicates a potentially hazardous situation which, if not avoided, **may** result in minor or moderate injury. It may also be used to alert against unsafe practices that may result in property-damage-only accidents.

1.3 BUCJAC B200-V SAFETY RULES

1. Only trained personnel shall operate the BucJac or do repairs. A trained person is one who has read and thoroughly understands this instruction manual and related equipment manuals and, through training and experience, has shown knowledge regarding the safe operational procedures.
2. Construction area is to be kept clear of unauthorized personnel at all times. Place barricades or secure the area in such a manner that no personnel would be injured by falling objects.
3. Safety equipment worn by operators must include, as a minimum, safety goggles, hard hats, safety shoes, and gloves.
4. Never operate the BucJac under the influence of drugs, alcohol, or medication.
5. Do not use the BucJac when you are tired or fatigued.
6. Do not use a BucJac that shows any signs of damage.
7. Never try using the BucJac in any application for which it was not designed.
8. Do not use any substitute for the lifting chain provided with the BucJac.
9. Never try using any power source other than 12 volts.
10. Use the remote control pendant to operate the BucJac and hooked-up post from a safe distance. Serious injury may occur if a loose post falls on personnel.
11. Keep clothing and all parts of the body away from moving parts of the BucJac when connected to the power supply or when being used. No personnel should be standing within the 10-foot radius of the control pendant cord during operation.
12. Do not attempt to adjust the BucJac during operation.

13. Use a wood or metal pole as needed to reposition the chain for taking another bite. Do NOT use your hand or foot to push the chain.
14. Always disconnect the electric power when servicing the BucJac or when not using the equipment.

2 SPECIFICATIONS

2.1 INTRODUCTION

Your Reimann & Georger Corp. B200-V BucJac provides up to 8000 pounds of pulling power using a heavy-duty 2-inch hydraulic cylinder. It can be easily connected to any 12-volt vehicle battery. U-posts, 4 x 4's, 6 x 6's, and even deep-set utility poles can be pulled quickly and easily.

2.2 TECHNICAL DATA

Weight	78 lbs.
Dimensions w/o leg extensions	23" H x 19" W x 19" D
Hydraulic cylinder	2" x 12" heavy duty
Construction	Anodized structural aluminum
Remote control	Weatherproof 2-button
Hydraulic pump system	12 volt
Power requirements	5-75 amps @ 12 volts
Maximum lifting power	8000 lbs.
No-load lifting rate	5' per minute
Lifting chain	3 ft. 3/8" chain w/ attached slip ring
Chain attachment/adjustment	LinkLok™
Leg extensions (optional)	Structural aluminum, 18" with welded foot pads

2.3 RECOMMENDED HYDRAULIC OIL

Many types of compatible hydraulic oil are available through your local dealer/distributor. As an original equipment manufacturer, RGC supplies a Grade ISO VG 32 hydraulic turbine oil. Hydraulic oil types are too numerous to list in this manual. If you have any question concerning the type of oil suitable for BucJac operation, please consult your local supplier or Reimann & Georger Corp. for details.

2.4 NAMEPLATE AND SERIAL NUMBER TAG

It is important to identify your BucJac completely and accurately whenever ordering spare parts or requesting assistance in service. The BucJac has a product nameplate, which states the model and serial numbers. The BucJac label should appear as the sample nameplate shown in Figure 2-1. Record the model and serial numbers for future reference.



Figure 2-1.
Typical BucJac Product Nameplate

MODEL _____

SERIAL NUMBER _____

3 OPERATION

3.1 BEFORE OPERATING THE BUCJAC

1. Only trained personnel shall operate this equipment. A trained person is one who has read and thoroughly understands this instruction manual and related equipment manuals and, through training and experience, has shown knowledge regarding the safe operational procedures.
2. Safety equipment worn by operators must include, as a minimum, safety goggles, hard hats, safety shoes, and gloves.
3. When carrying the BucJac to its operating position, observe the following precautions:
 - a. Insure power source is disconnected to avoid accidental operation.
 - b. Bend your knees and lift with your legs.
4. Construction area is to be kept clear of unauthorized personnel at all times. Place barricades or secure the area in such a manner that no personnel would be injured by falling objects.

3.2 SETUP PROCEDURE

1. Insure that the hydraulic fluid level is adequate in the pump reservoir.
2. To prevent fluid leakage during shipment, a shipping plug is installed in the reservoir fill. During operation, the reservoir must be vented by unscrewing the shipping plug and installing the vented cap provided. Tighten the vented cap securely, but do not over-tighten.



WARNING:

NEVER REMOVE THE SHIPPING PLUG WHILE THE BUCJAC IS RUNNING OR REINSTALL THIS PLUG AT THE END OF A PROJECT WHILE THE HYDRAULIC FLUID IS STILL HOT.

LIQUID UNDER HIGH PRESSURE CAN PIERCE THE SKIN, CAUSING SERIOUS INJURY OR DEATH. HOT LIQUID CAN CAUSE SERIOUS PERSONAL BURNS. IF AN INJURY OCCURS, GET IMMEDIATE MEDICAL ATTENTION.

3. The BucJac is supplied with 25-foot power cables that connect to a 12-volt power source. Two jumper cables are supplied also that permanently connect to the terminals on your vehicle battery. Attach the RED cable to the POSITIVE terminal on your battery and attach the BLACK cable to the NEGATIVE battery terminal. NEVER try using any power source other than 12 volts.
4. After connecting the jumper cables, thread them through the grill of your vehicle and plug together the quick disconnect ends of the jumper cables and the 25-foot power cable. See Figure 3-1.

3.3 POST PULLING PROCEDURE

1. Place the BucJac against the post to be pulled, with the legs of the BucJac straddling each side of the post. For additional stability on soft or sloping terrain, use the optional leg extensions.
2. Wrap the chain around the post and “thread” the end through the cinch ring of the chain. Bring the chain up through the eye of the BucJac. Pull the chain to remove as much slack as possible. See Figure 3-2. Do NOT use any substitute for the lifting chain provided.

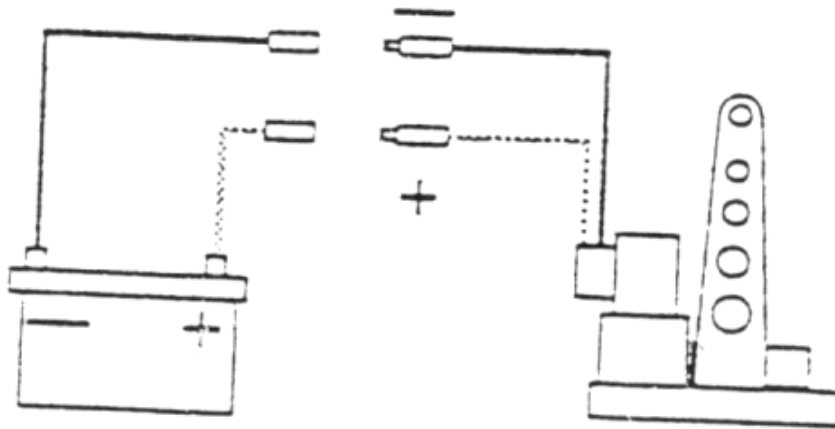

Figure 3-1.
12-Volt Power Connection

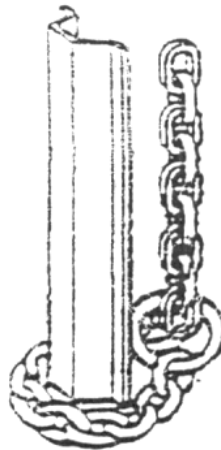

Figure 3-2.
Chain Installation on Post to Be Pulled

3. Secure the chain by sliding the Link-Lok into the chain around one of the links and between two adjoining links. See Figure 3-3. If the slack has been taken out of the chain properly, the operator should not have to remove and re-install the LinkLok™ during the post pulling.
4. Insure the jumper and power cables are connected together to supply 12-volt power to the BucJac.
5. Take the remote control pendant to where you can control the BucJac from a safe distance.



WARNING:

PINCH-POINTS, MOVING EQUIPMENT, AND A FALLING LOOSE POST CAN CAUSE SERIOUS PERSONAL INJURY. THEREFORE, NOBODY SHOULD BE STANDING WITHIN THE 10-FOOT RADIUS OF THE CONTROL PENDANT CORD DURING OPERATION.

6. Press the button marked UP to take up whatever slack may be in the chain. Check that the entire setup has been done correctly, the unit is operating properly, and that all personnel are cleared from the area. Press the UP button again and hold until the BucJac reaches the top of its stroke.

7. Press the DOWN button to lower the BucJac. When the BucJac retracts all the way down, reposition the chain if needed to take another bite. Use a wood or metal pole to do this—do NOT use your hand or foot to push the chain. Keep taking bites until the post is loose or out of the ground completely.

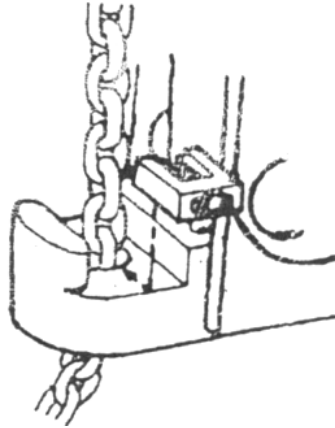

Figure 3-3.
LinkLok™ Installation

3.4 SHUTDOWN AND STORAGE

1. Always disconnect the electric power when servicing the BucJac or when not using the equipment. Secure the BucJac and power supply to prevent unauthorized use.
2. Store the BucJac away from excessive heat or moisture. Store in a clean, dry area away from exposure to high humidity, liquids, or freezing temperatures.
3. At the end of a project and ONLY with the hydraulic fluid at ambient temperature, replace the vented cap on the reservoir with the shipping plug. This will prevent leakage during transfer to a new job site.

4 INSPECTION AND MAINTENANCE

4.1 GENERAL MAINTENANCE RULES

1. Proper maintenance of the BucJac requires timely adhering to all the guidelines given in this chapter. Proper maintenance is required to maintain the system in good condition and free of defects.
2. Review and follow all the safety rules given in Chapter 1 before attempting any maintenance.



CAUTION:

BEFORE STARTING ANY MAINTENANCE, DISCONNECT THE ELECTRIC POWER SOURCE TO PREVENT ACCIDENTAL STARTUP.



WARNING:

DURING ANY MAINTENANCE OR REPAIR PROCEDURES, DO NOT ATTEMPT ANY POST PULLING. THIS CAN CAUSE EQUIPMENT DAMAGE AND/OR SERIOUS PERSONAL INJURY.

4.2 REQUIRED MAINTENANCE

The BucJac requires little maintenance **except** for the following:

1. Check the function and performance of the BucJac periodically.
2. Before each use, insure that all broken, worn or defective parts are repaired or replaced. Check that all hardware on the BucJac is tight.
3. Check the hydraulic oil level periodically. The cylinder must be retracted with the oil at ambient temperature during this procedure. Add standard hydraulic oil if needed using the guidelines given in Chapter 2.
4. During long periods of storage or if in a climate of temperature extremes, check for condensation in the reservoir that may freeze prior to each use. Change the oil if it contains condensate.

5 TROUBLESHOOTING

The following chart is intended to assist with troubleshooting the B200-V 12-volt BucJac. While not all inclusive, the chart outlines the most common causes of a problem and the recommended course of action.

SYMPTOM	CAUSE AND CORRECTIVE ACTION
<p>BucJac does not start when UP button is pressed on control pendant.</p>	<p>Vehicle battery is dead—recharge or replace as required.</p> <p>Poor electrical connection:</p> <ul style="list-style-type: none"> a. Corroded battery terminals—clean as required. b. Poor connection at the quick disconnect between the jumper and power cables—insure the cables are fully engaged into the quick disconnect.
<p>BucJac operates, but is not pulling up the post.</p>	<p>Vehicle battery is weak—recharge or replace as required.</p> <p>Post to be pulled is hitting an obstruction—remove obstruction with the BucJac turned off.</p> <p>BucJac not positioned properly against the post—BucJac must be perpendicular to the ground for maximum lifting power.</p> <p>Required lifting power exceeds the maximum 8000-lb. rated capacity of the BucJac—do NOT use the BucJac in this situation. Equipment damage and/or personal injury can occur.</p> <p>Hydraulic oil level low—add standard hydraulic oil as required with the reservoir oil at ambient temperature and the cylinder retracted.</p>

6 PARTS LIST

The following parts list applies to the B200-V BucJac only. Each item number in the following parts list can be matched with the item number shown on the Figure 6-1 assembly drawing which follows.

Item Number	Part Number	Quantity	Description
1	2412501	1	Chain Set Assembly
2	5842614	1	Shackle, 3/8
3	5842615	1	Cinch Ring
4	5842405	1	Chain, Steel 3/8
5	6025011	1	Hydraulic Cylinder
6	2414405	1	Cylinder Sleeve
7	5622058	1	Fitting
8	6022202	1	Return Tube
9	6024004	1	Pump
10	5622041	1	Fitting
11	6026006	1	Breather
12	2411503	1	Reservoir
13	6022201	1	Pressure Tube
14	5622121	1	Fitting
15	5441401	2	Starter Solenoid
16	2455001	1	Base Assembly
17	2412431	1	LinkLok™
18	2442401	1	Lanyard
19	2455002	1	Draw Bar Assembly
20	5842308	8	Nut 1/2" Grade 8
21	2412412	4	Tie Rods
22	5842608	2	1/2" Snap Ring
23	2412438	1	Handle Pin
24	2412430	1	Cross Pin
25	5842609	2	1" Snap Ring
26	2411117	1	Mounting Plate
27	5441404	1	Cable Assembly
28	5441403	1	Control Pendant

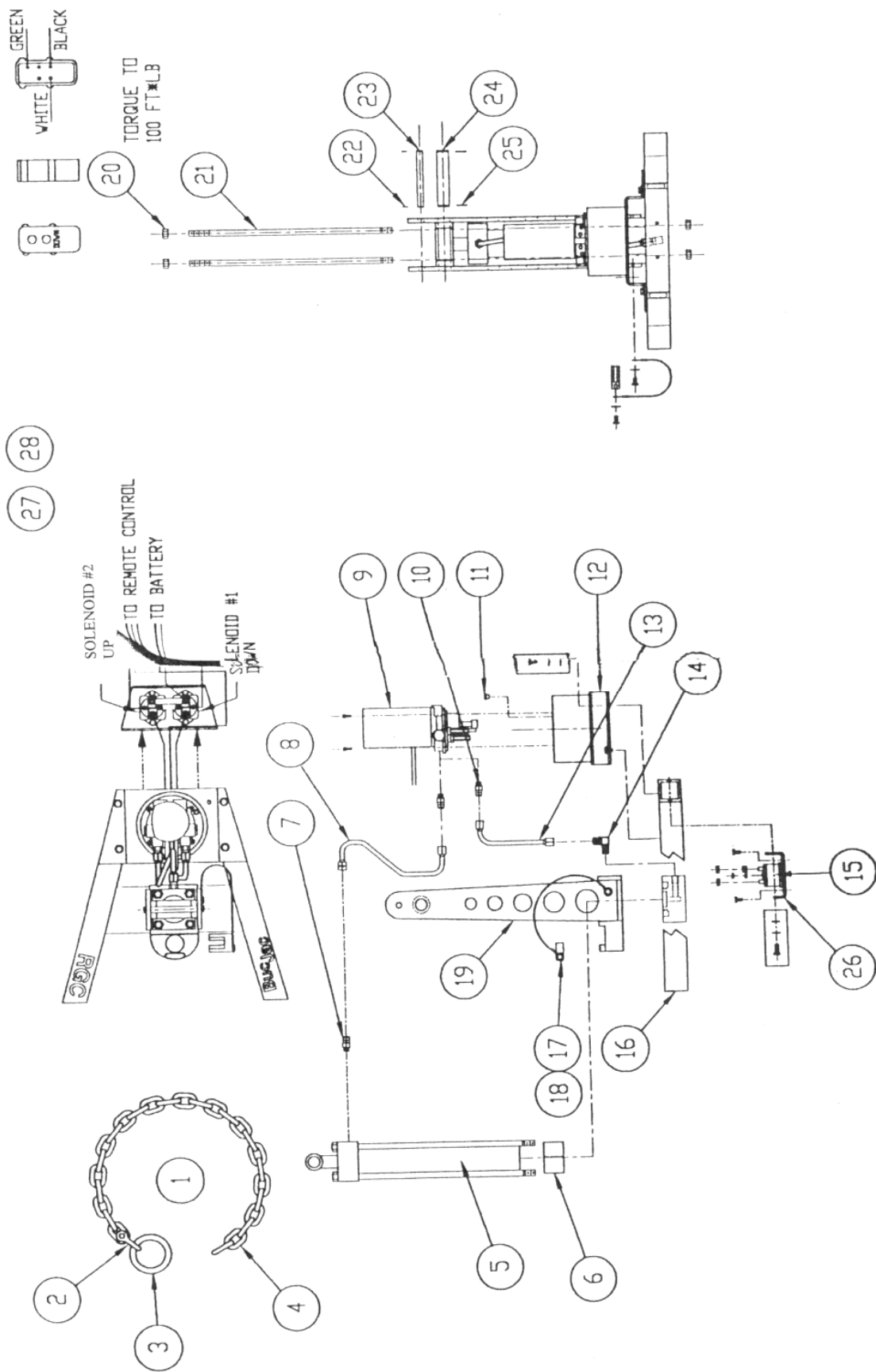

Figure 6-1.
B200-V BucJac Assembly

LIMITED WARRANTY

Reimann & Georger Corp. RGC CONSTRUCTION EQUIPMENT

For one (1) year from purchase, Reimann & Georger Corp., hereafter called the Corporation, will replace, or at its option, repair for the original purchaser, free of charge, any product or part thereof described in our RGC Construction Equipment product catalog, found upon examination by the Corporation to be defective in material or workmanship or both, provided that written notice is given to the Corporation at P.O. Box 681, Buffalo, New York 14240, within a reasonable time. The purchaser shall be responsible for all transportation charges and any cost of removing any part submitted for replacement under this warranty. **THERE IS NO OTHER EXPRESS WARRANTY.**

IMPLIED WARRANTIES, INCLUDING THOSE OF MERCHANTABILITY AND FITNESS FOR A PARTICULAR PURPOSE, ARE LIMITED TO ONE YEAR FROM PURCHASE. Some states do not allow limitations on how long an implied warranty lasts, so the above limitations may not apply to you. **THIS IS THE EXCLUSIVE REMEDY AND LIABILITY FOR INCIDENTAL AND CONSEQUENTIAL DAMAGES UNDER ANY AND ALL WARRANTIES IS EXCLUDED TO THE EXTENT EXCLUSION IS PERMITTED BY LAW.** Some states do not allow the exclusion or limitation of incidental or consequential damages, so the above limitation or exclusion may not apply to you.

In addition, the Corporation shall be relieved of its performance of the duties under this warranty if any defect of any warranted product is caused by damage (not resulting from defect) while in the possession of the consumer, or by unreasonable use (including failure to provide reasonable maintenance), or if such defect is attributable to an Act of God or such other event beyond the control of the Corporation. This warranty excludes any component of our product which is not manufactured by the Corporation.

This warranty gives you specific legal rights, and you may also have other rights which vary from state to state.