

VL2000 GUIDE ON

PARTS LIST

REF #	PART #	QTY	DESCRIPTION
1	3629425	2	VL2K GUIDE ON ASSY
2	3611610	4	VL GUIDE ON SUPPORT POST
3	3629529	4	VL2K GUIDE ON MTG BRKT WLDMT
4	9703593	4	3-HOLE PLATE 4-1/2"
A	5897017	8	HHCS 3/8-16 X 3-1/4 SS
B	5893507	4	3/8 X 3-1/2 CARRIAGE BOLT SS
C	5896377	4	3/8 HEX NUT SS
D	5896406	12	3/8 SAE FLAT WASHER SS
E	5806243	12	3/8 SPLIT LOCK WASHER SS
F	5803638	8	3/8 BRONZE HEX NUT
G	5896282	4	1/2 X 1-1/2 HEX HEAD CAP SCREW SS
H	5896385	4	1/2 SQUARE HEX NUT SS

1. Read the following instructions thoroughly before starting work. If you don't understand a procedure, call Reimann & Georger Corporation or its distributors for assistance.
2. Insure that you have all the parts listed. If any parts are missing or damaged, return to place of purchase immediately.
3. Attach the guide on mounting brackets to the load tube of the platform. Place the brackets so the tube is facing the inside of the platform of the lift. Fasten into place using a three hole plate, two hex head bolts, two flat washers, two lock washers, and two 3/8 bronze hex nuts but do not fully tighten the nuts.
4. Place the guide on support posts onto the guide on assembly using a carriage bolt, a flat washer, a lock washer, and a 3/8 hex nut.
5. With the support posts on the guide on assembly, slide the support posts through the tubes on the guide on mounting brackets on the platform. Adjust to desired height and tighten into place using a 1/2" cap screw and square nut.
6. Once the guide ons with support posts are fastened into place in the mounting brackets, position the guide ons to the desired location and tighten the bronze nuts on the hex bolts to fasten into place. Refer to Figure 1.

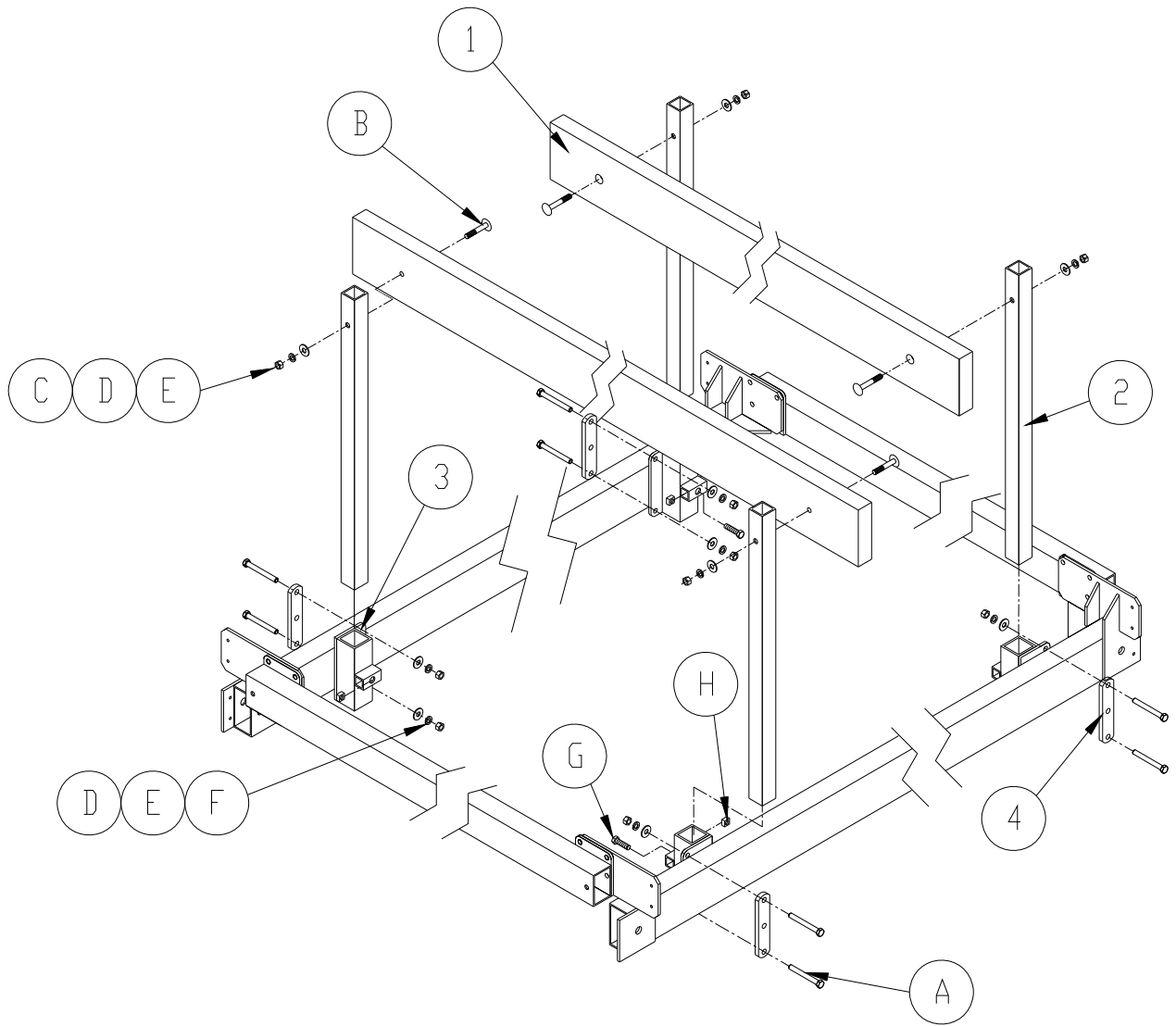

Figure 1